

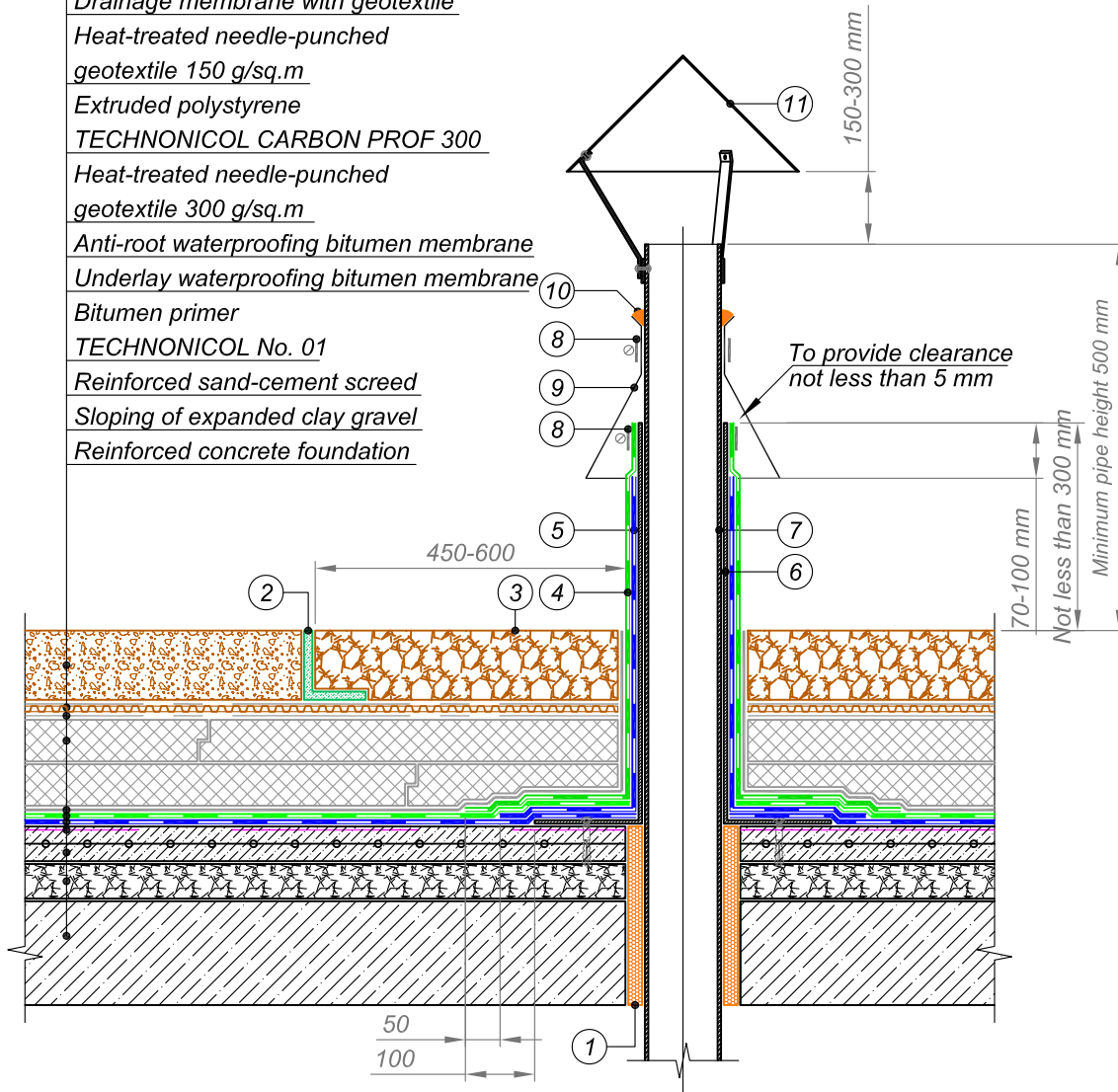

- Plant substrate with green planting
- Drainage membrane with geotextile
- Heat-treated needle-punched geotextile 150 g/sq.m
- Extruded polystyrene
- TECHNONICOL CARBON PROF 300
- Heat-treated needle-punched geotextile 300 g/sq.m
- Anti-root waterproofing bitumen membrane
- Underlay waterproofing bitumen membrane
- Bitumen primer
- TECHNONICOL No. 01
- Reinforced sand-cement screed
- Sloping of expanded clay gravel
- Reinforced concrete foundation



- ① Sealing foam
- ② L-shaped plastic element
- ③ Washed gravel
- ④ Cap sheet bitumen membrane
- ⑤ Underlay bitumen membrane
- ⑥ Galvanized steel sleeve not less than 1 mm in thickness
- ⑦ Pipe
- ⑧ Compression metal clamp
- ⑨ Metal rain collar
- ⑩ Sealing mastic
- ⑪ Roof cowl

NOTES

The solution is used for single cold pipes up to 250 mm in diameter, anchors, antenna bracings

GREEN ROOF				DESIGN	APPROVED
JUNCTION TO COLD PIPE				SCALE	DATE
REV.	DATE	DESCRIPTION	CHECKED	DWG No.	REV.