

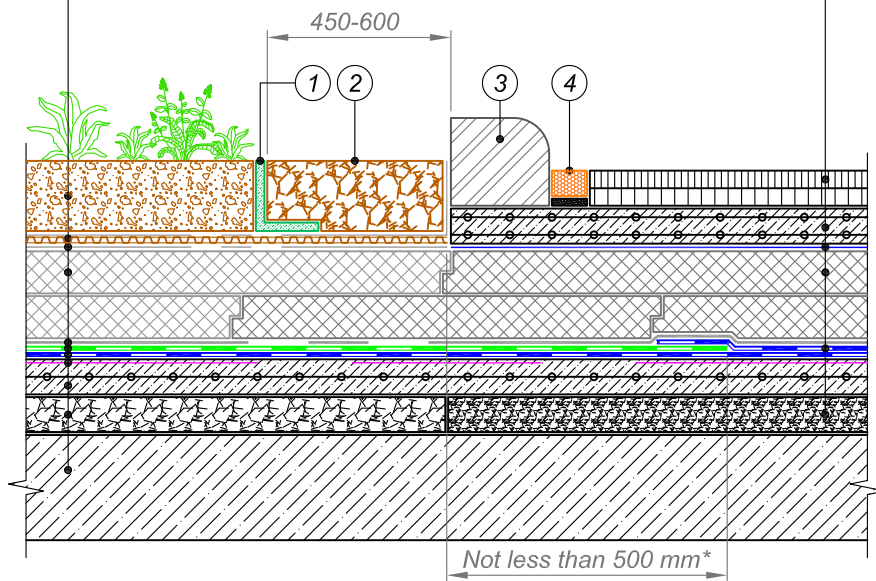

- Plant substrate with green planting
- Drainage membrane with geotextile
- Heat-treated needle-punched geotextile 150 g/sq.m
- Extruded polystyrene TECHNOMIC CARBON PROF 300
- Heat-treated needle-punched geotextile 300 g/sq.m
- Anti-root waterproofing bitumen membrane
- Underlay waterproofing bitumen membrane
- Bitumen primer TECHNOMIC No. 01
- Reinforced sand-cement screed
- Sloping of expanded clay gravel
- Reinforced concrete foundation
- Two layers of asphaltic concrete
- Reinforced concrete slab
- Polyethylene film
- Extruded polystyrene TECHNOMIC CARBON
- Underlay bitumen membrane
- Sloping of claydite concrete



- ① L-shaped plastic element
- ④ Polymer-bitumen sealant on layer of sand
- ② Washed gravel
- ③ Kerb stone

NOTES

** Anti-root waterproofing bitumen membrane to be taken up on the roof section using another roofing system by the amount of not less than 500 mm

				GREEN ROOF	DESIGN	APPROVED
					SCALE	DATE
REV.	DATE	DESCRIPTION	CHECKED	CONJUGATION WITH TRAFFIC AREA	DWG No.	REV.